

P13

Flexible

Mechanism

Open: P12-Flexible demo



Switch Apps

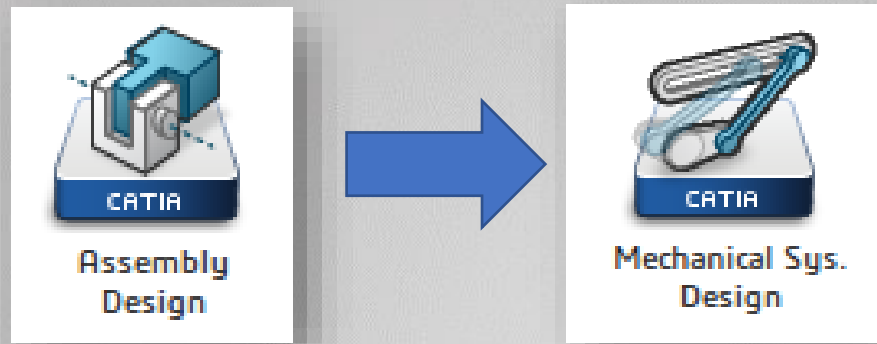

Can do everything

Tools needed for this Problem



Fix



Engineering Connection



Mechanism Representation



Mechanism Manager



Mechanism Player



Theory

The Actual Steps (Step by Step demo)



Theory

Assembly

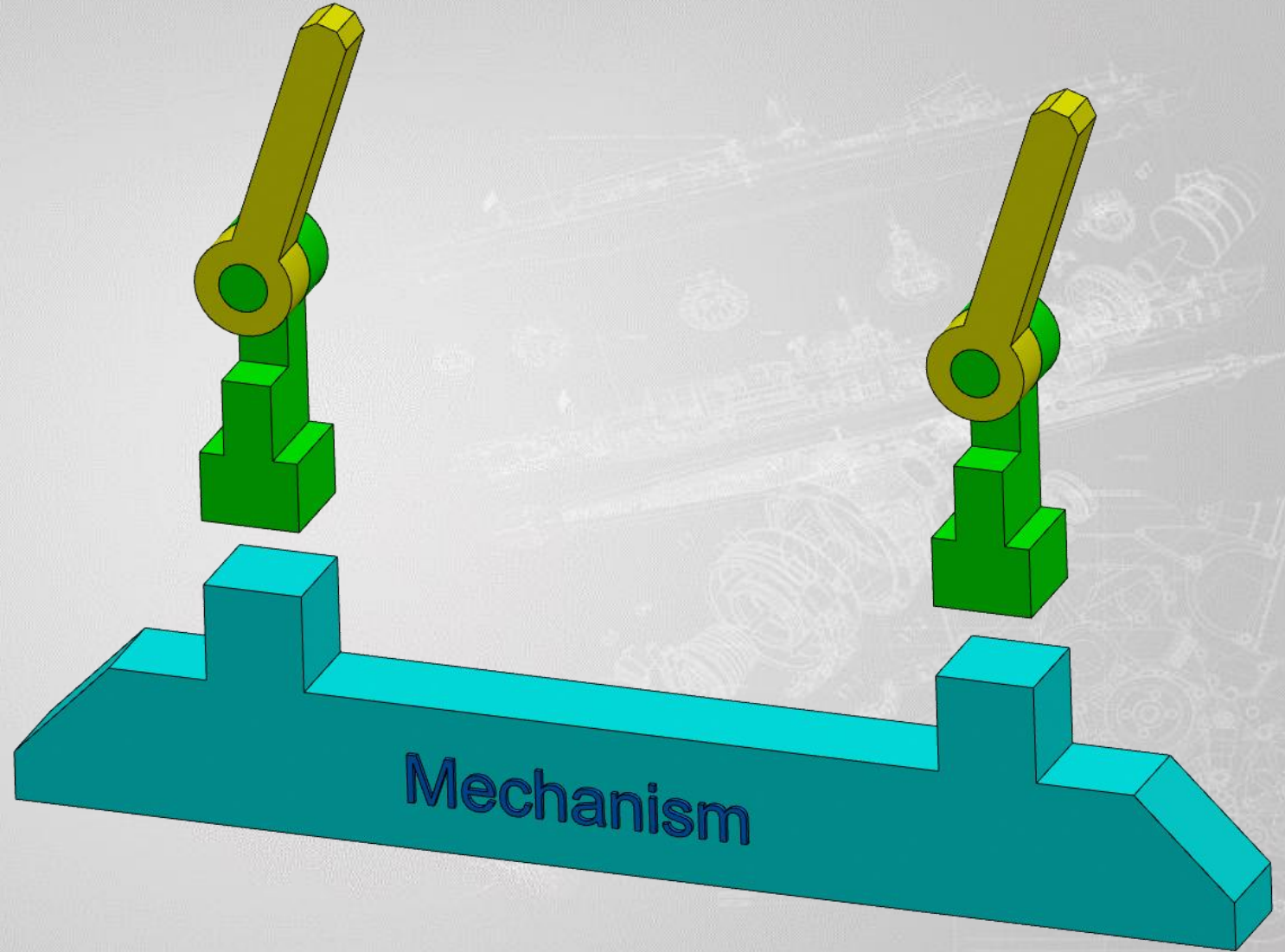
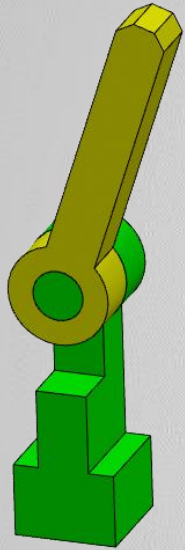

Theory

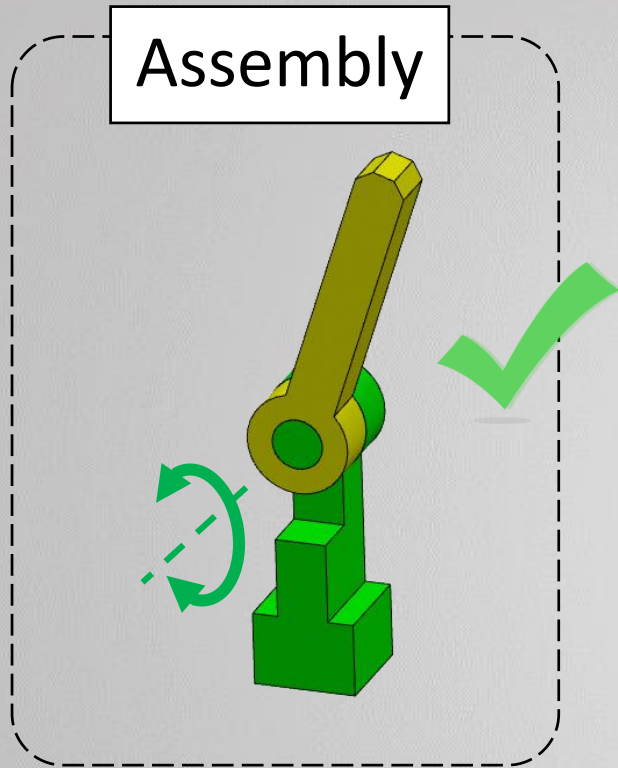

Theory

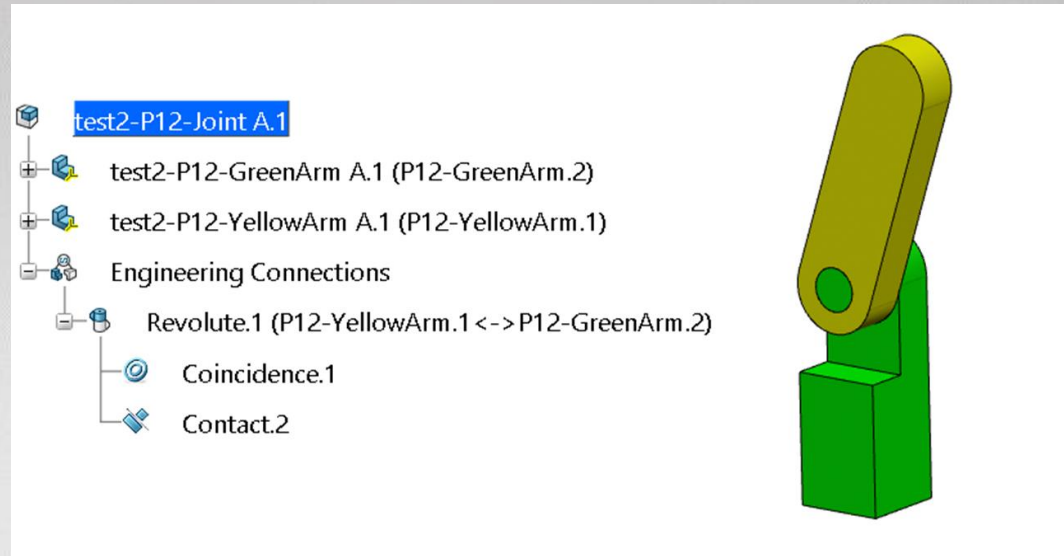
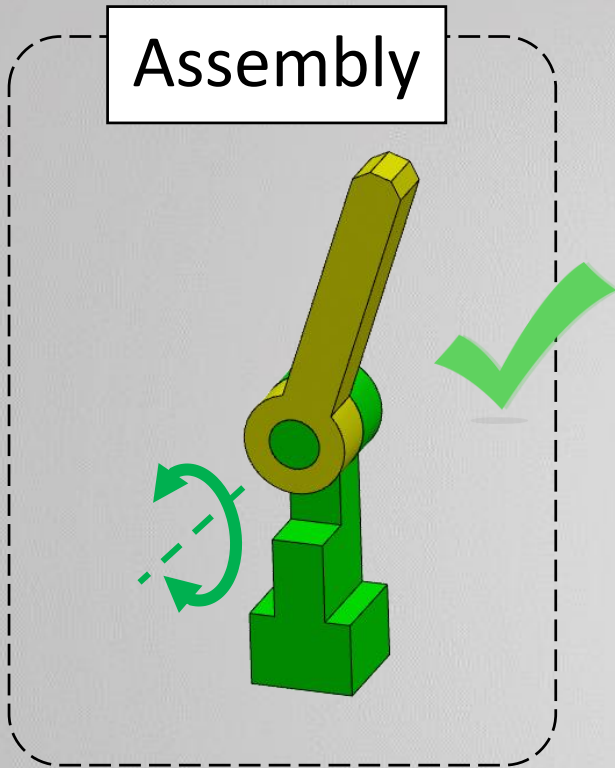

Theory

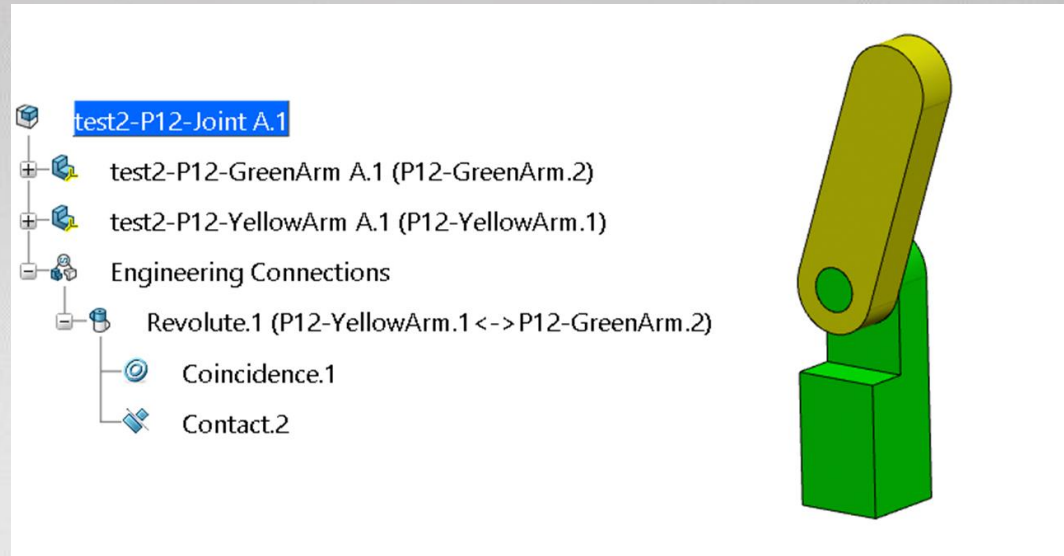
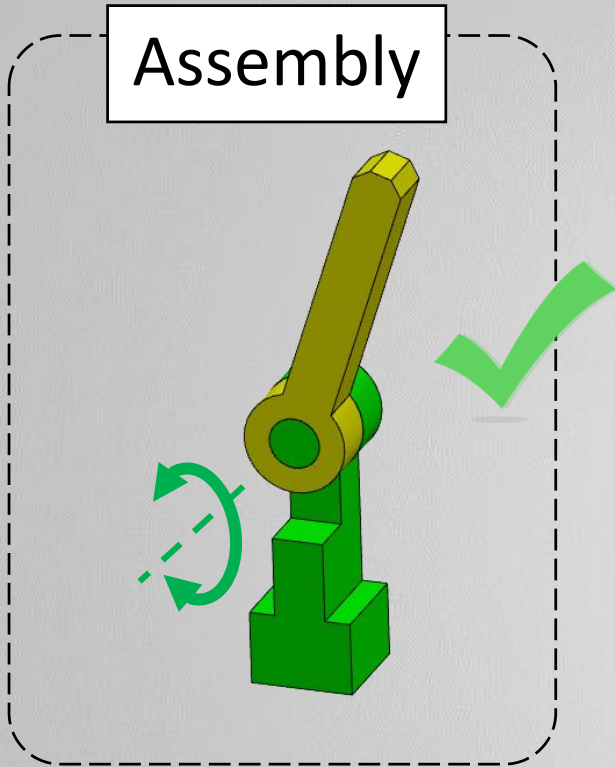

Controlled →

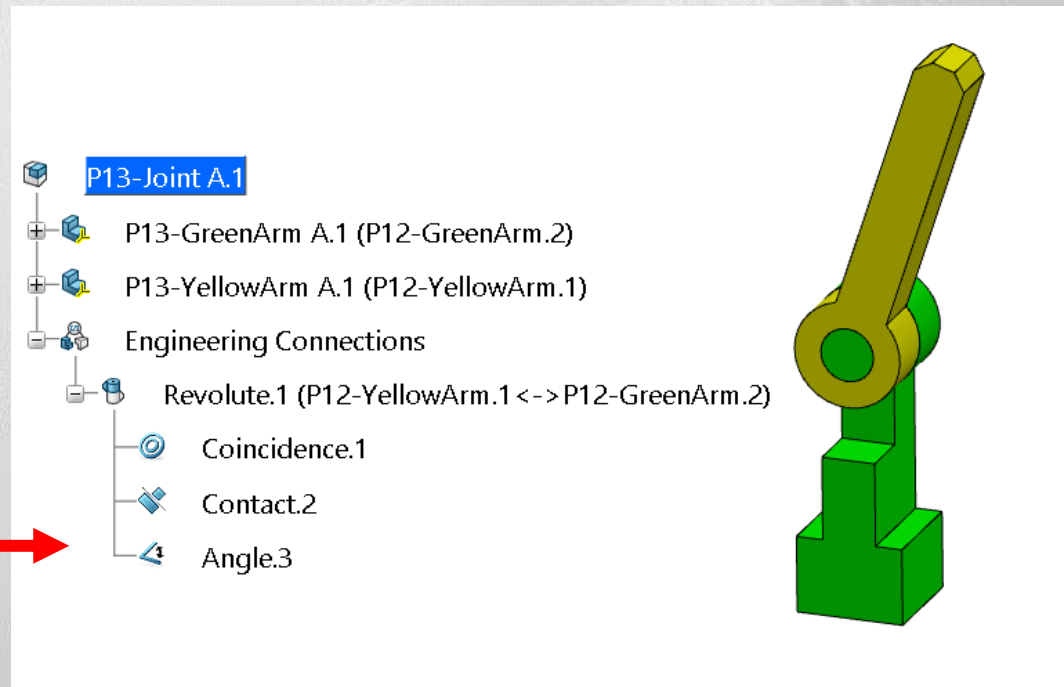

Theory

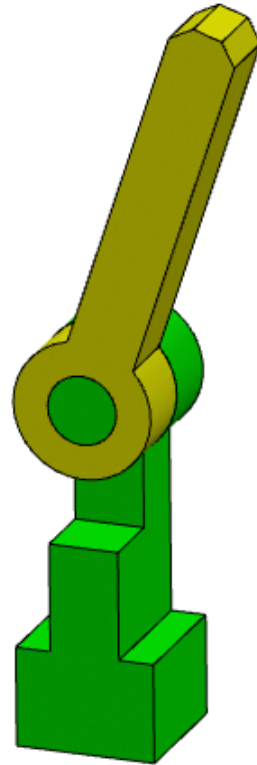
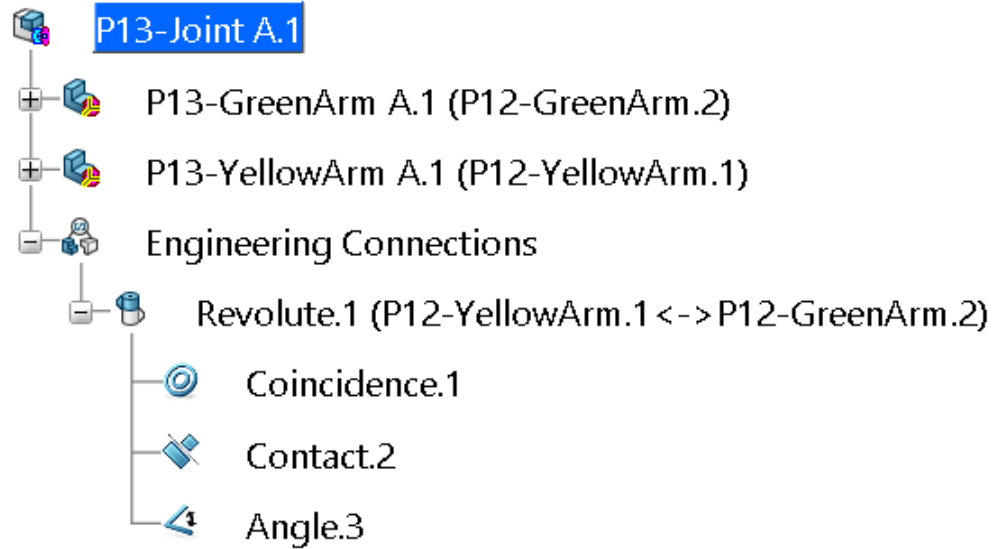

Properties

Current selection : P13-Joint A.1

Reference | Part | Graphic | Mechanical Behavior | Revisions

Flexibility

Flexible at instantiation

Repositionable Instances

	Instance	Sub-Tree	Analyze
P12-GreenArm.2	<input type="checkbox"/>	...	(?/?)
P12-YellowArm.1	<input type="checkbox"/>	...	(?/?)

More...

OK Apply Close



Going Forward

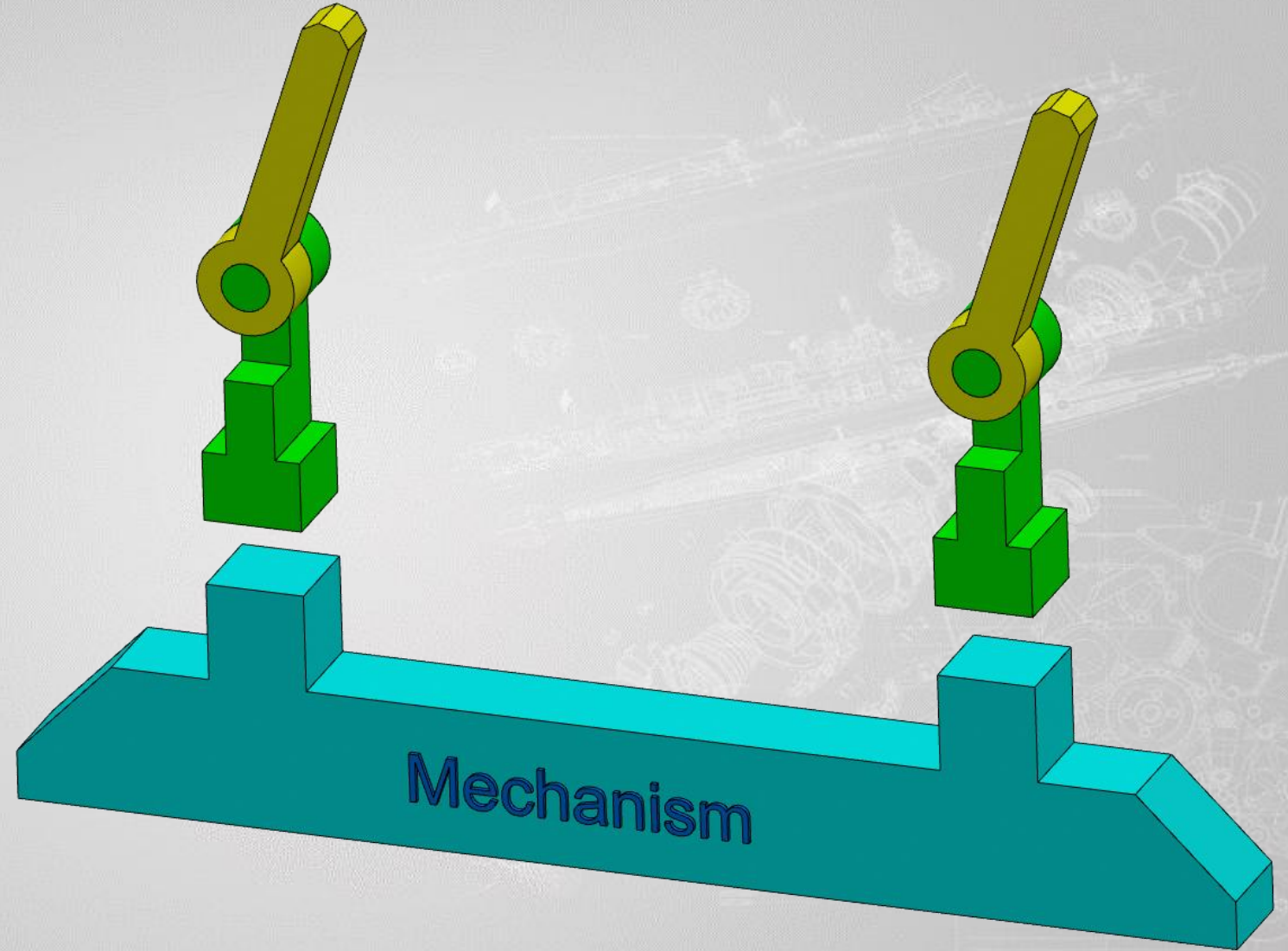

Update

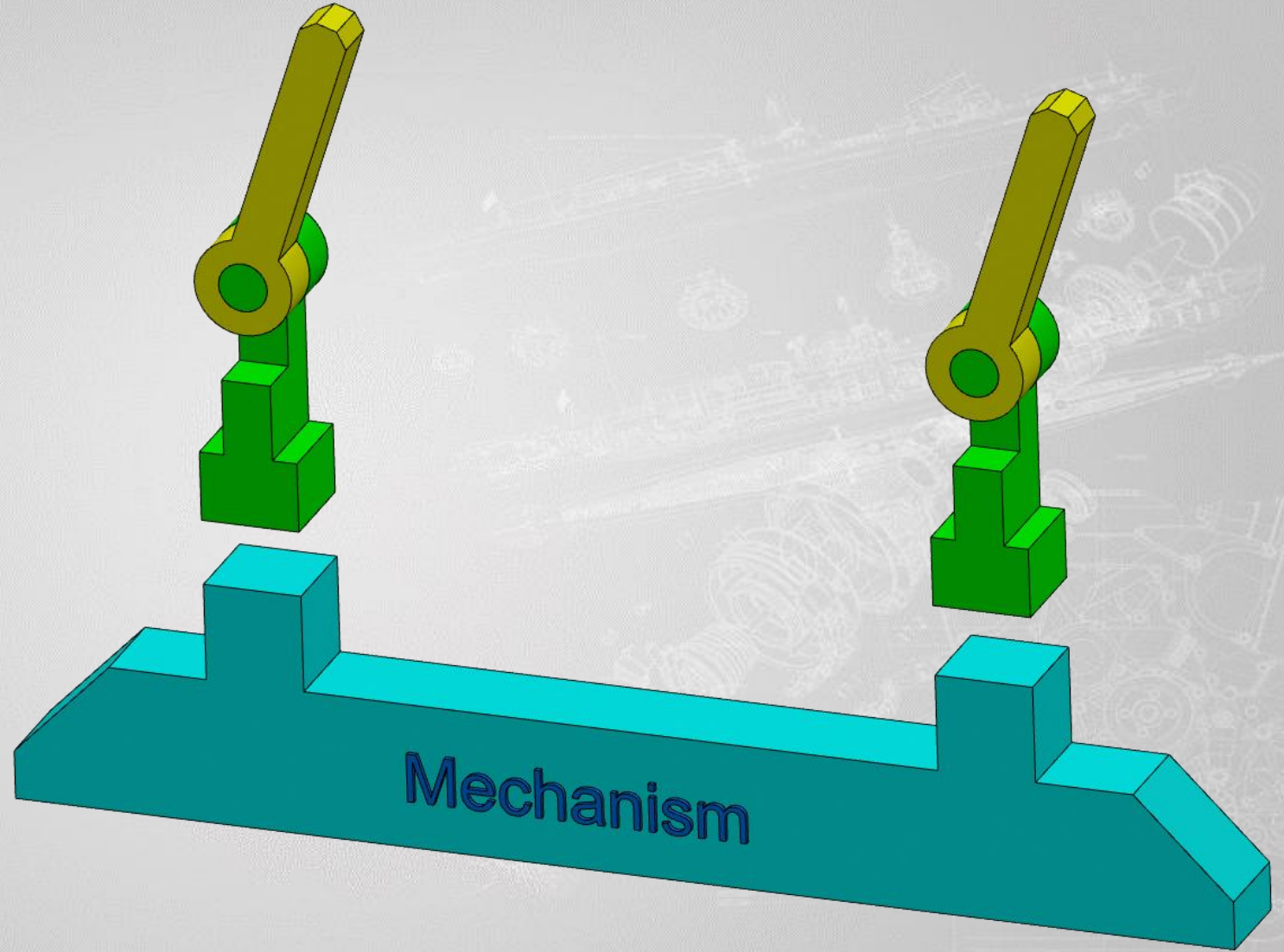
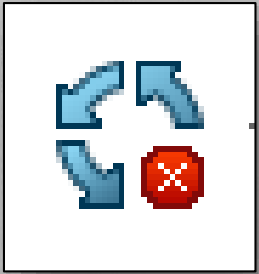

Propagate the EC's

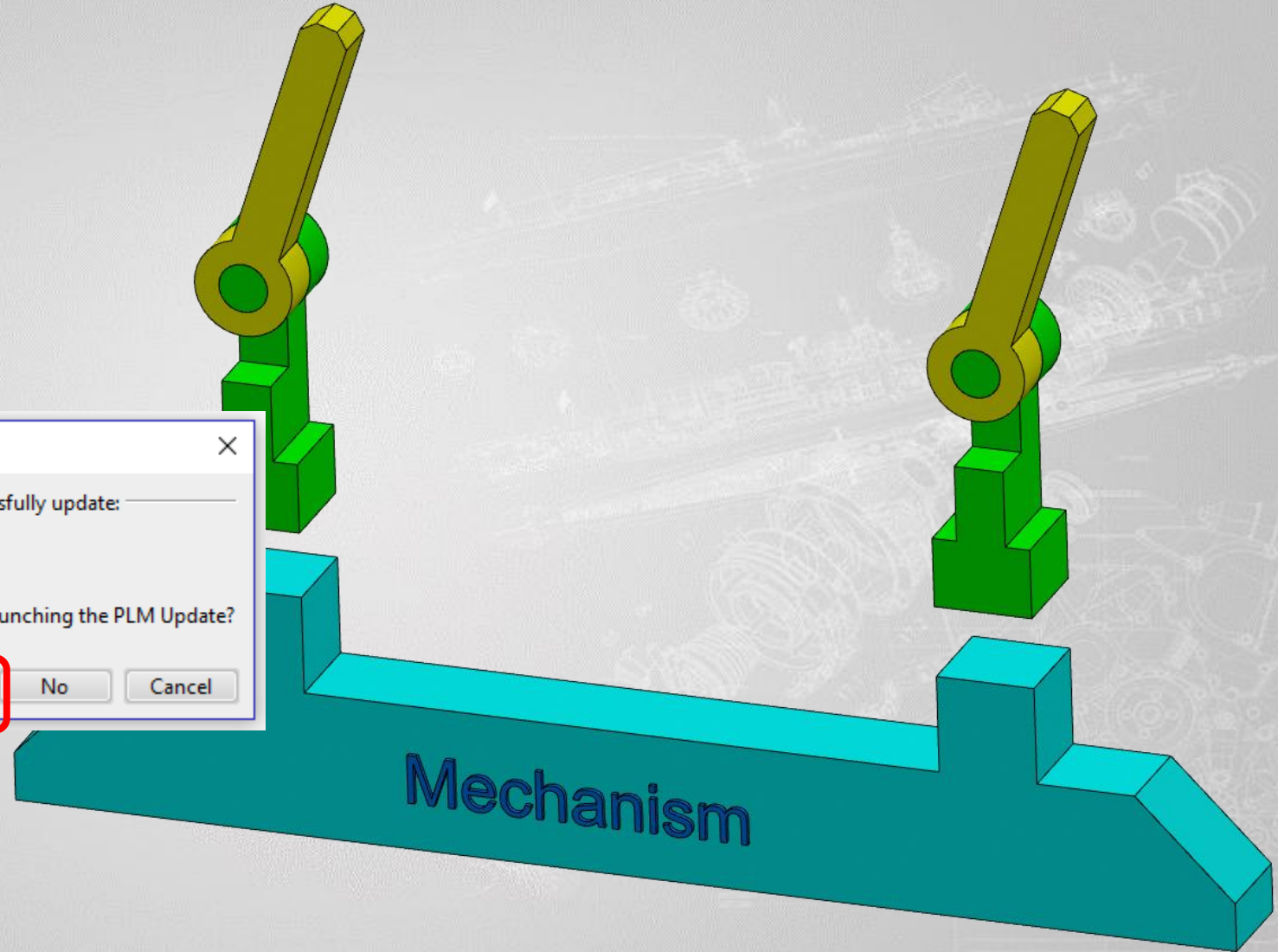
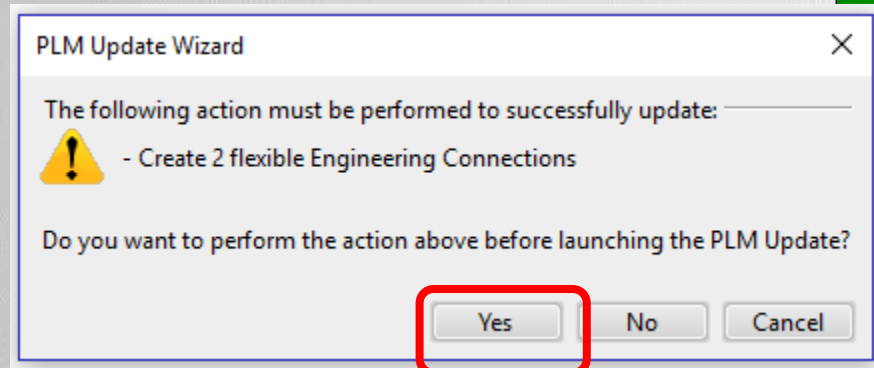
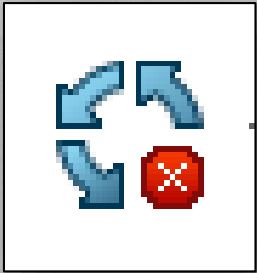

Overloaded EC's

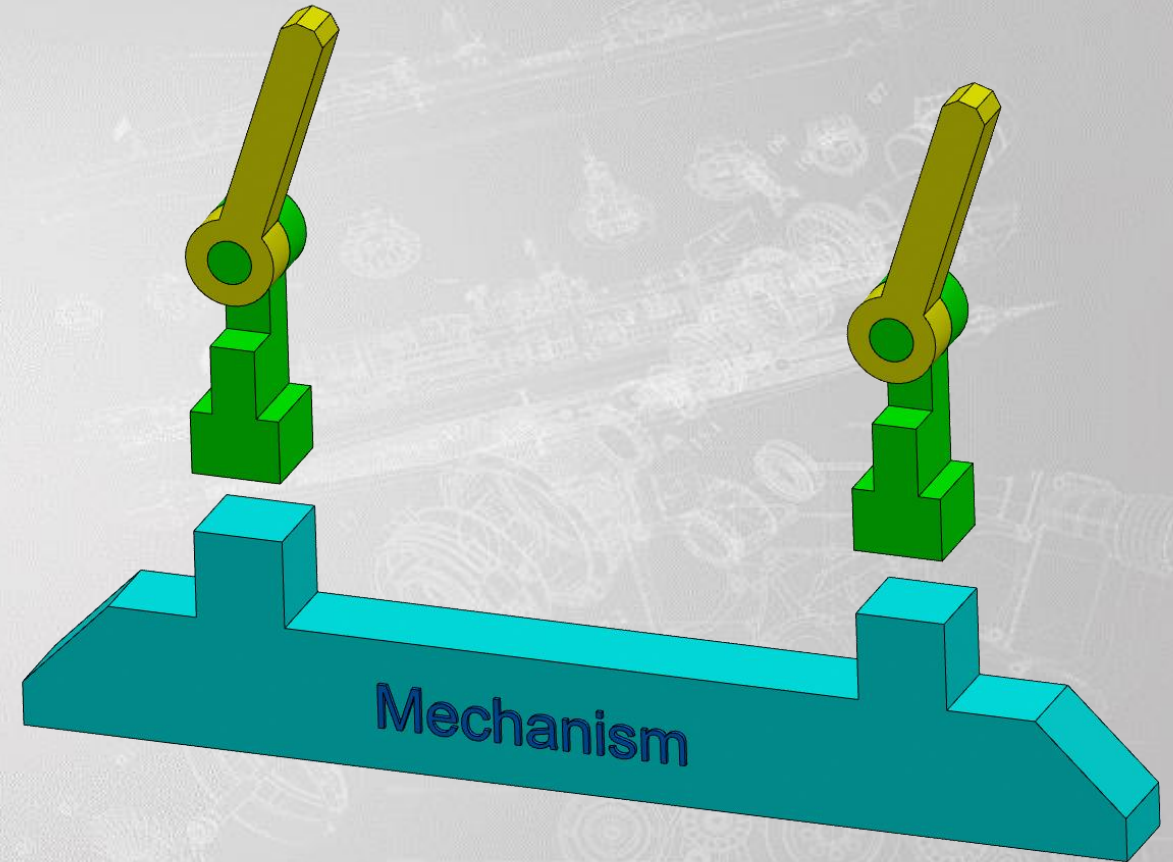
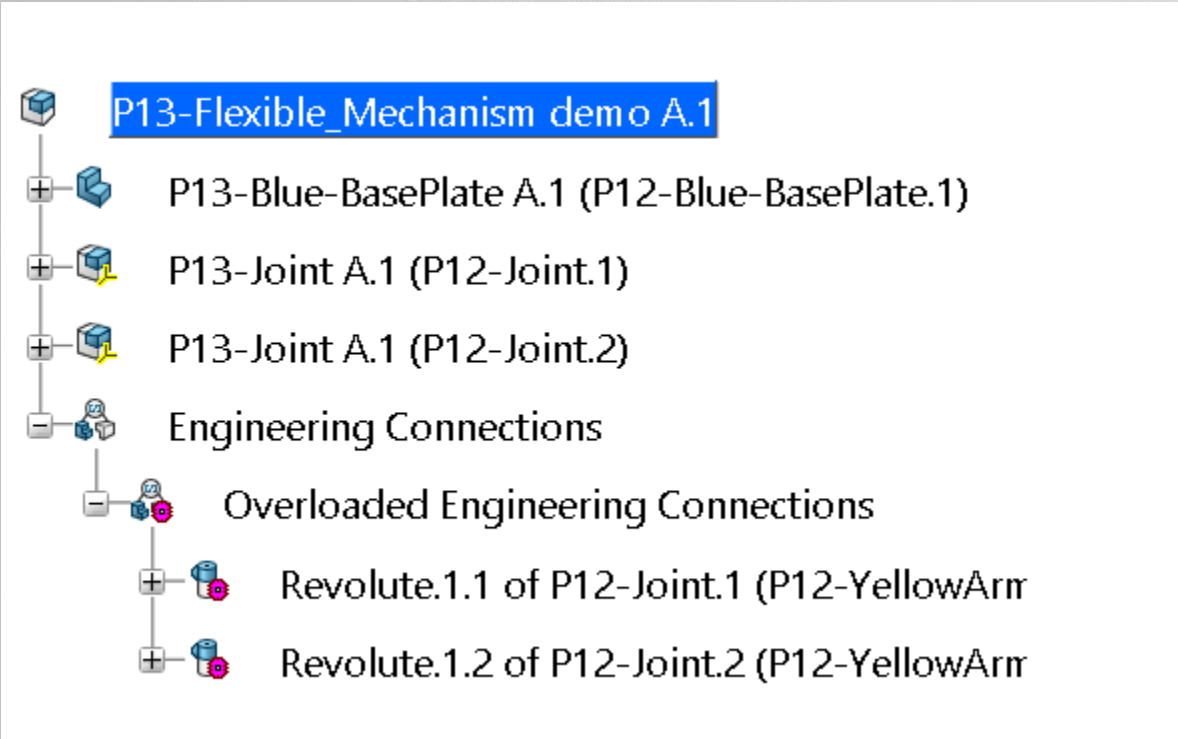

Add more EC's

- P13-Flexible_Mechanism demo A.1
 - P13-Blue-BasePlate A.1 (P12-Blue-BasePlate.1)
 - P13-Joint A.1 (P12-Joint.1)
 - P13-Joint A.1 (P12-Joint.2)
 - Engineering Connections
 - Overloaded Engineering Connections
 - Revolute.1.1 of P12-Joint.1 (P12-YellowArr)
 - Revolute.1.2 of P12-Joint.2 (P12-YellowArr)

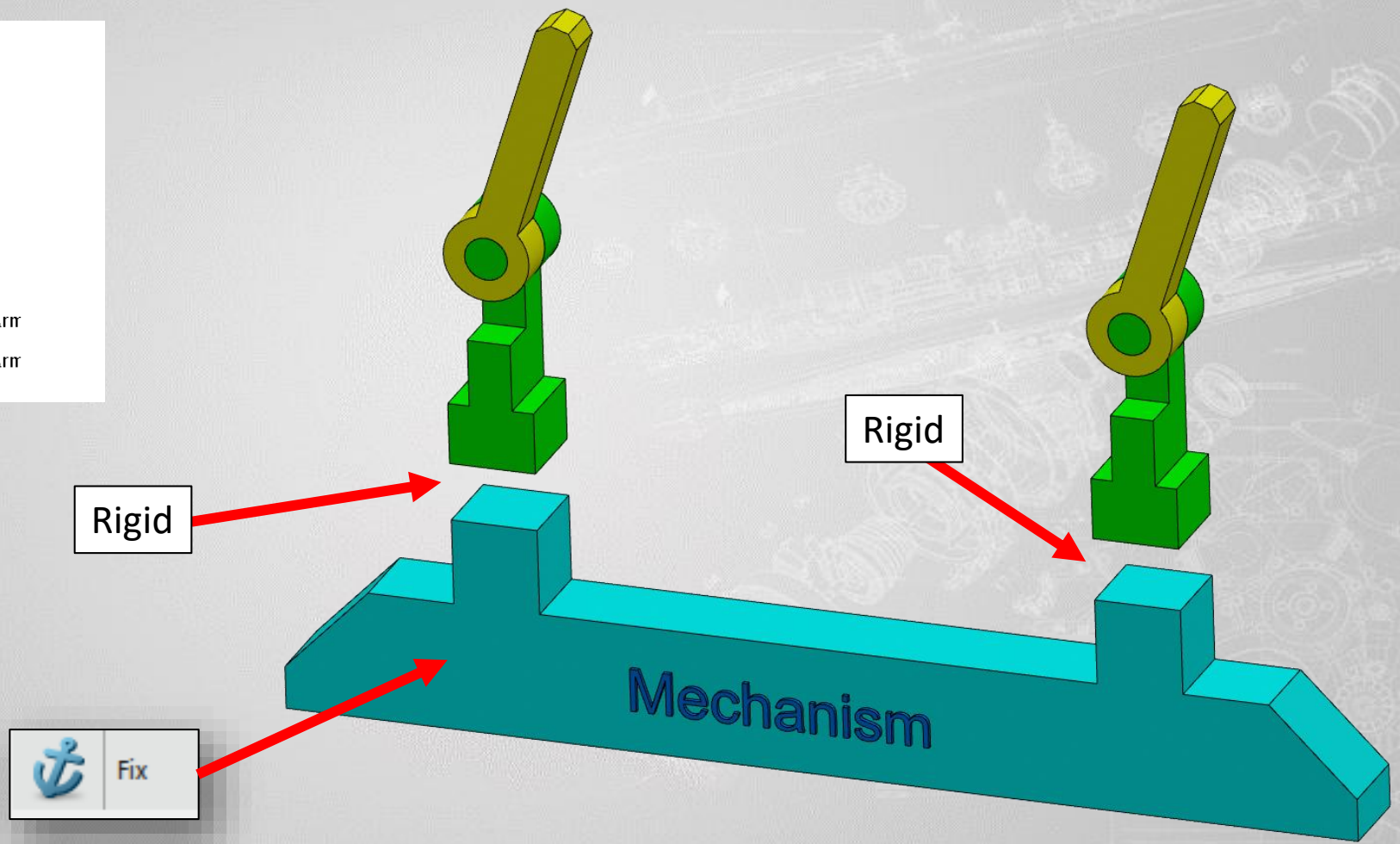

Add more EC's

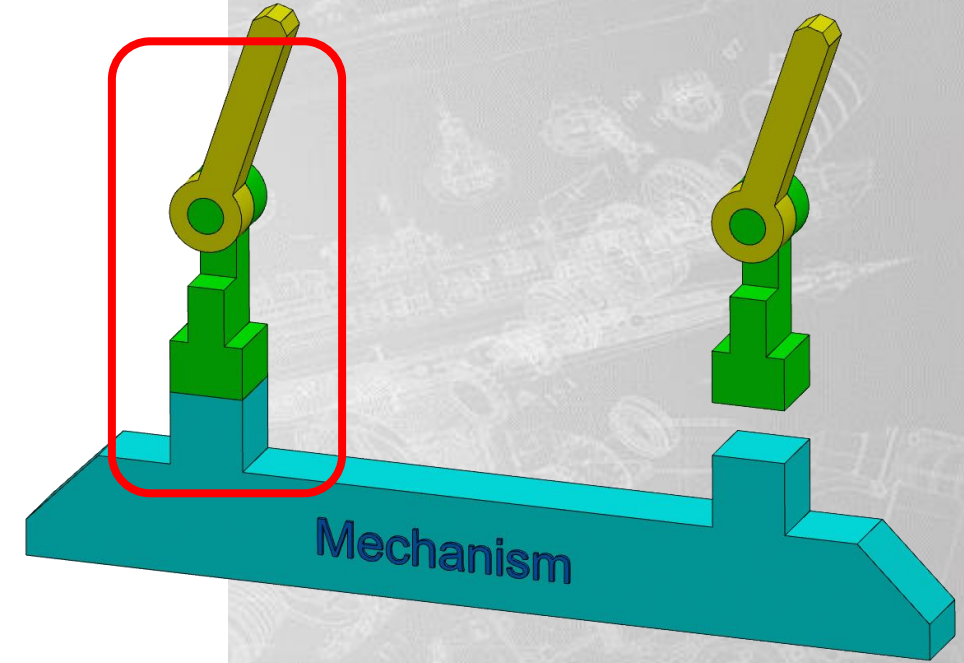
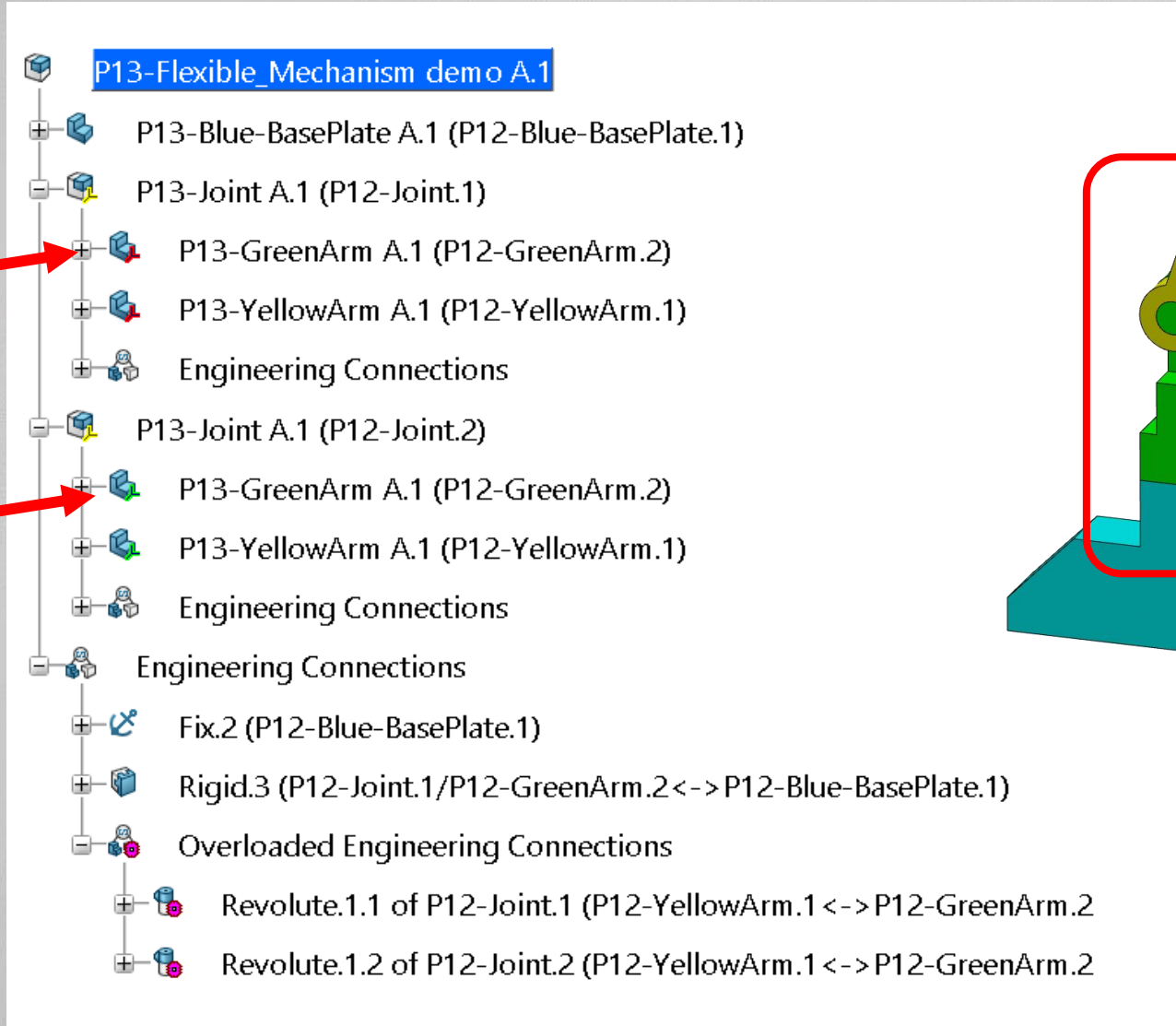

Add more EC's

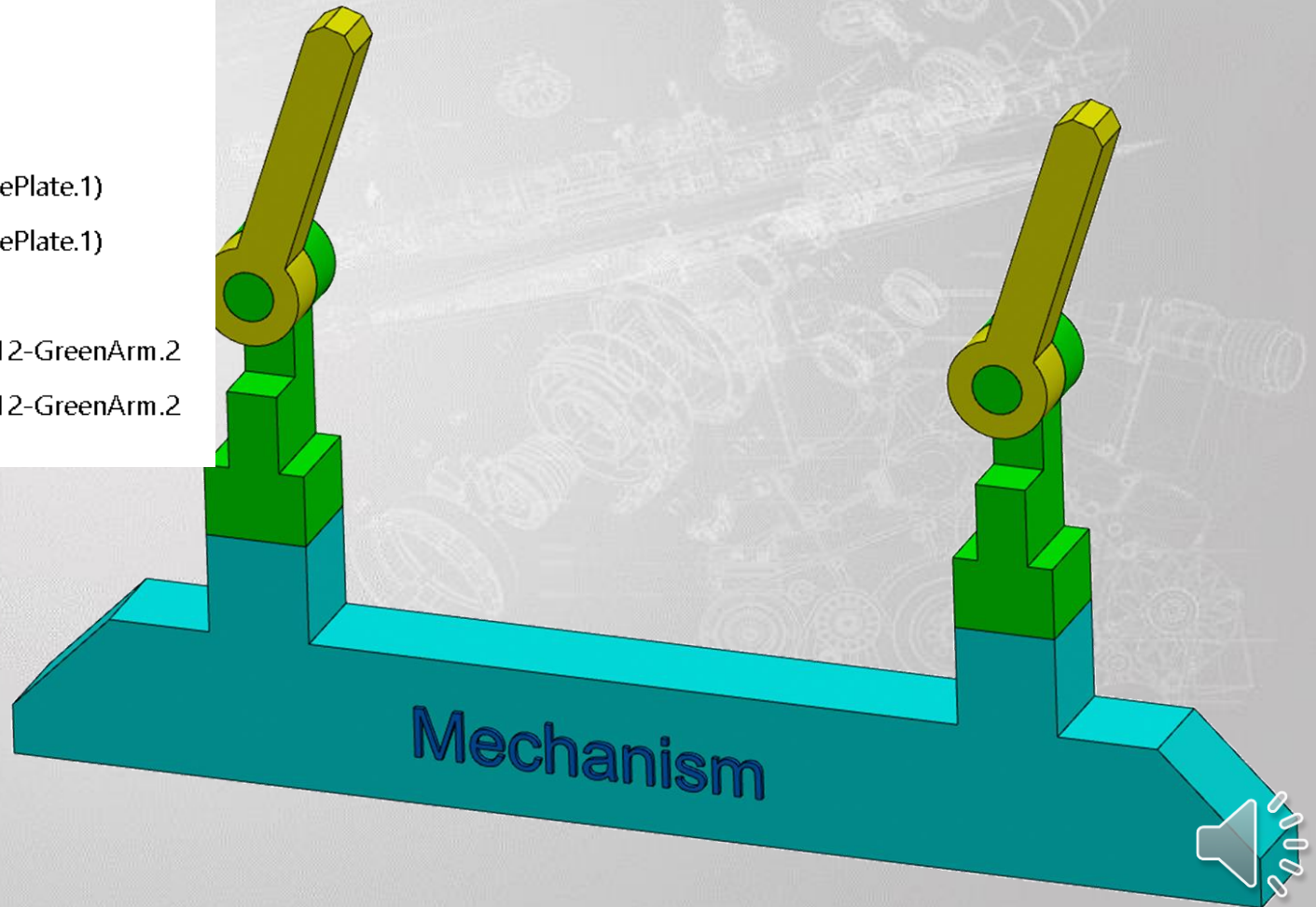
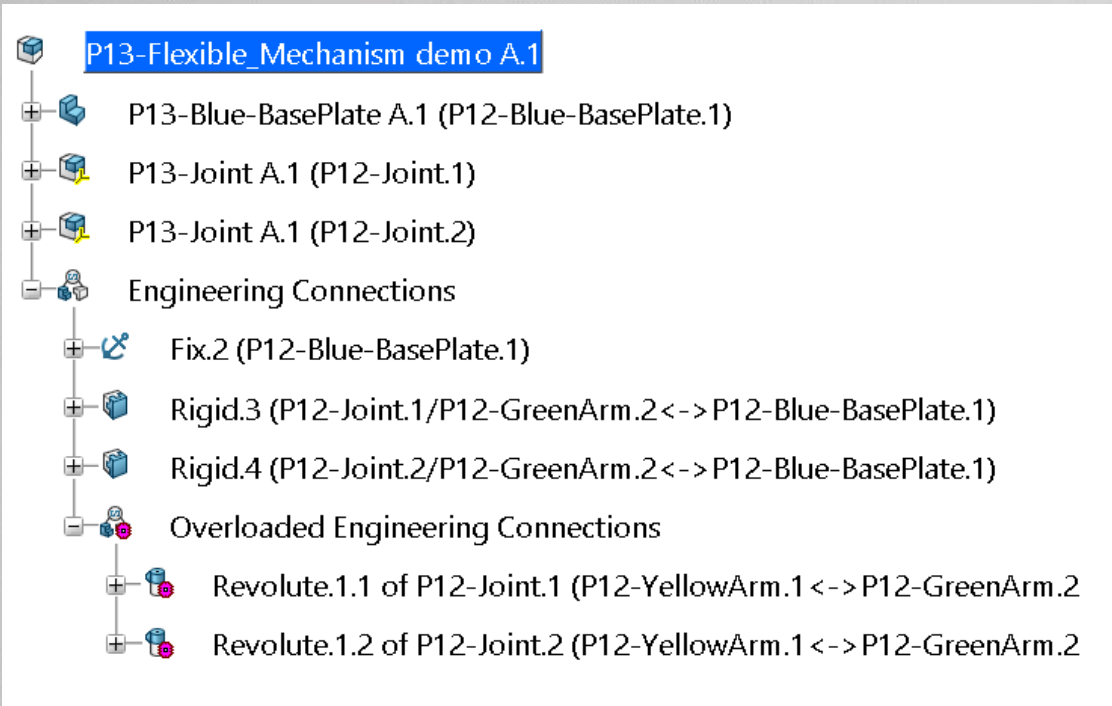

Add more EC's

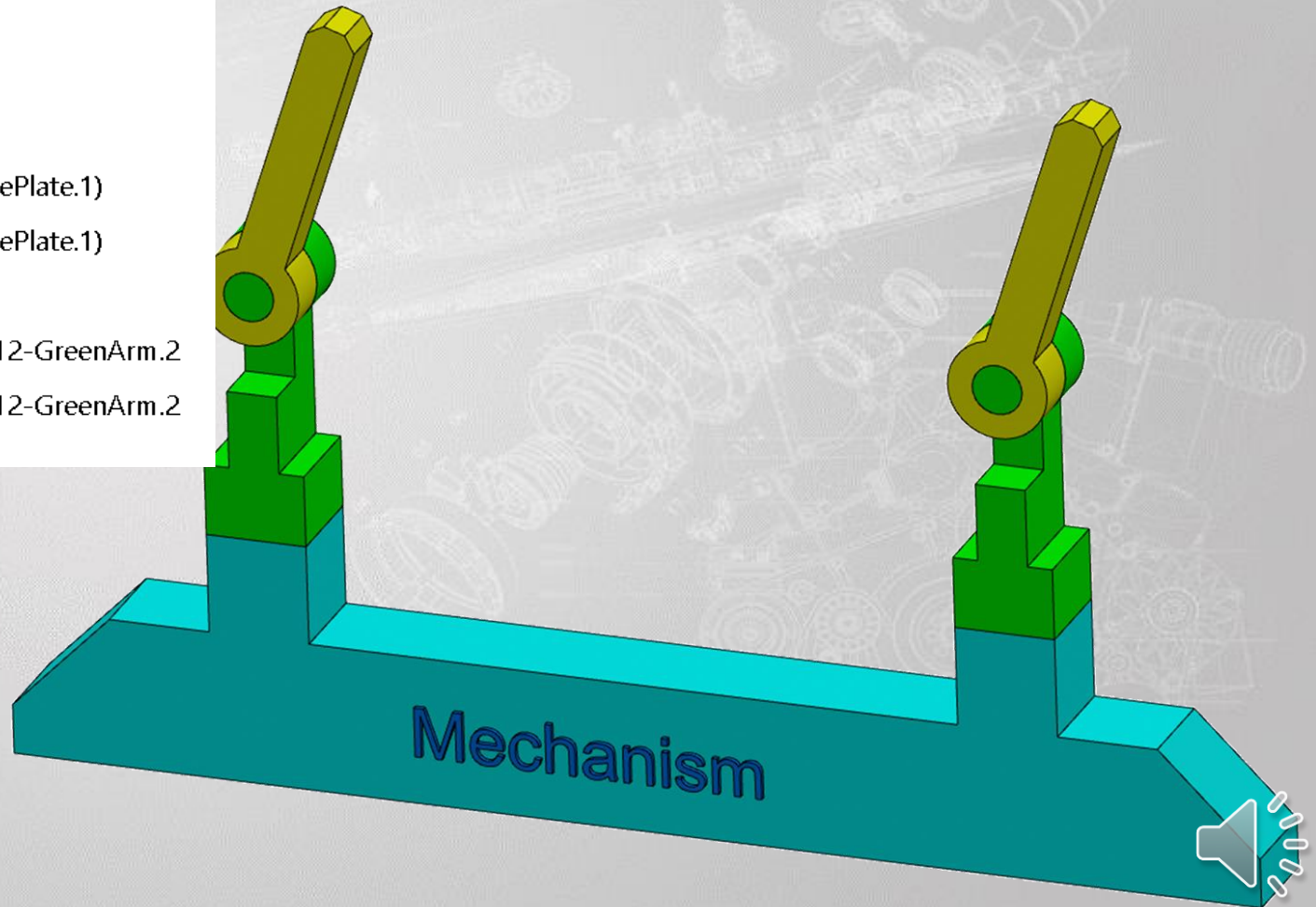
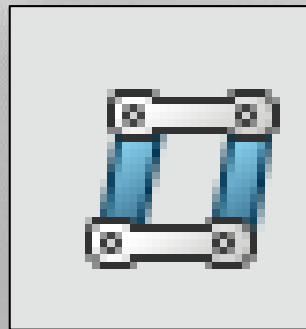
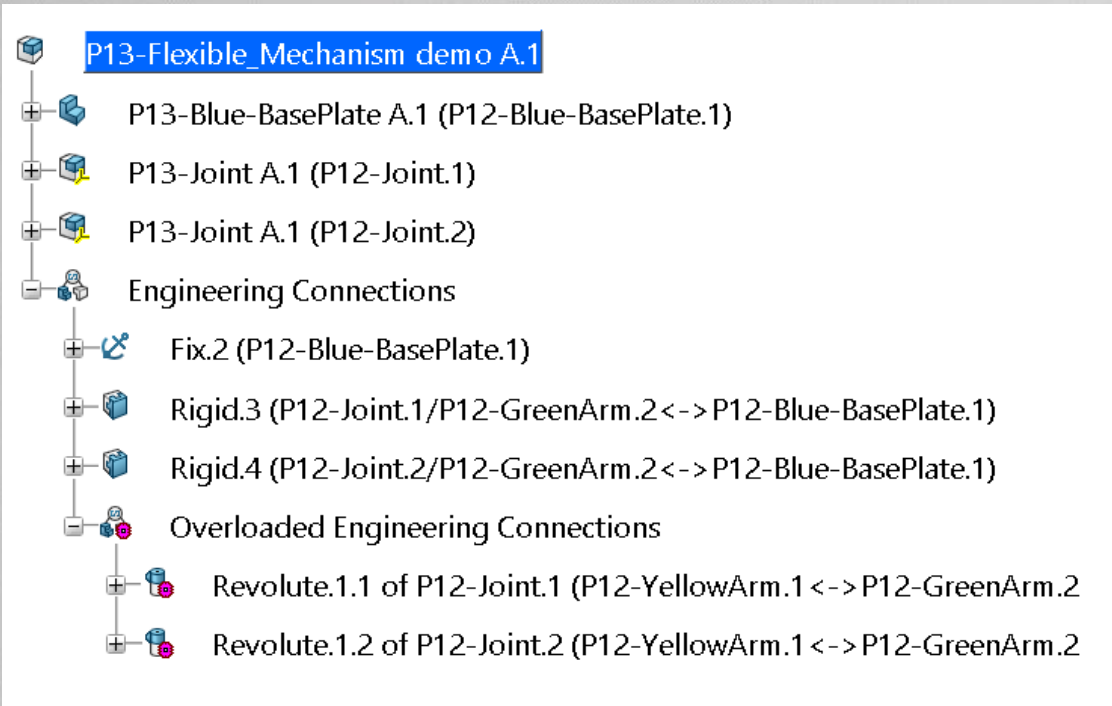

Add more EC's

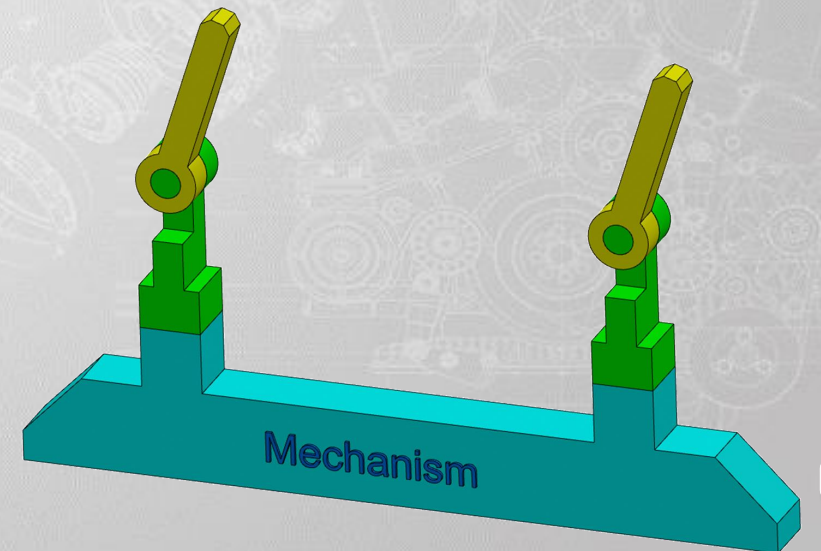
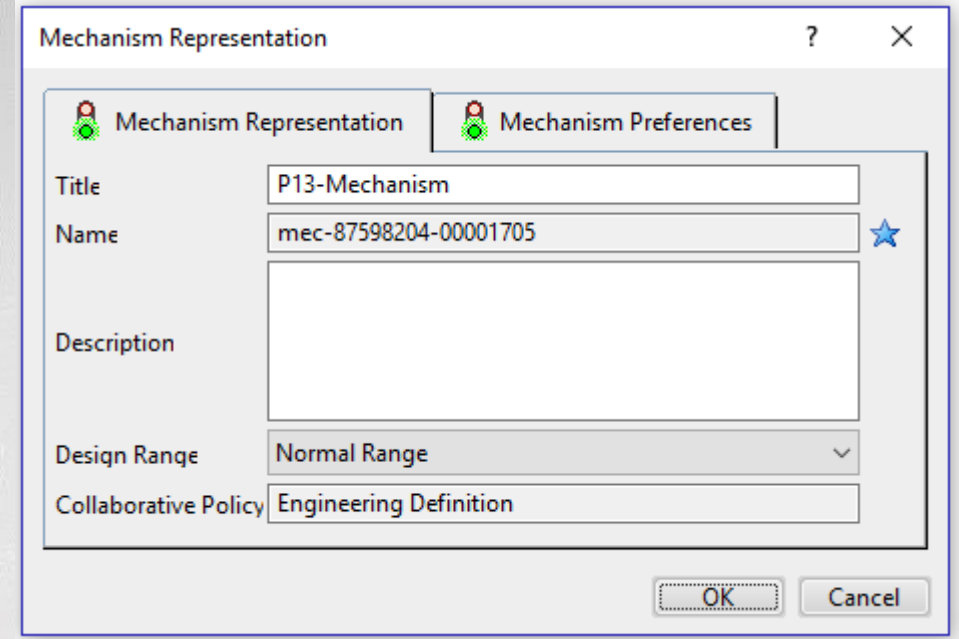
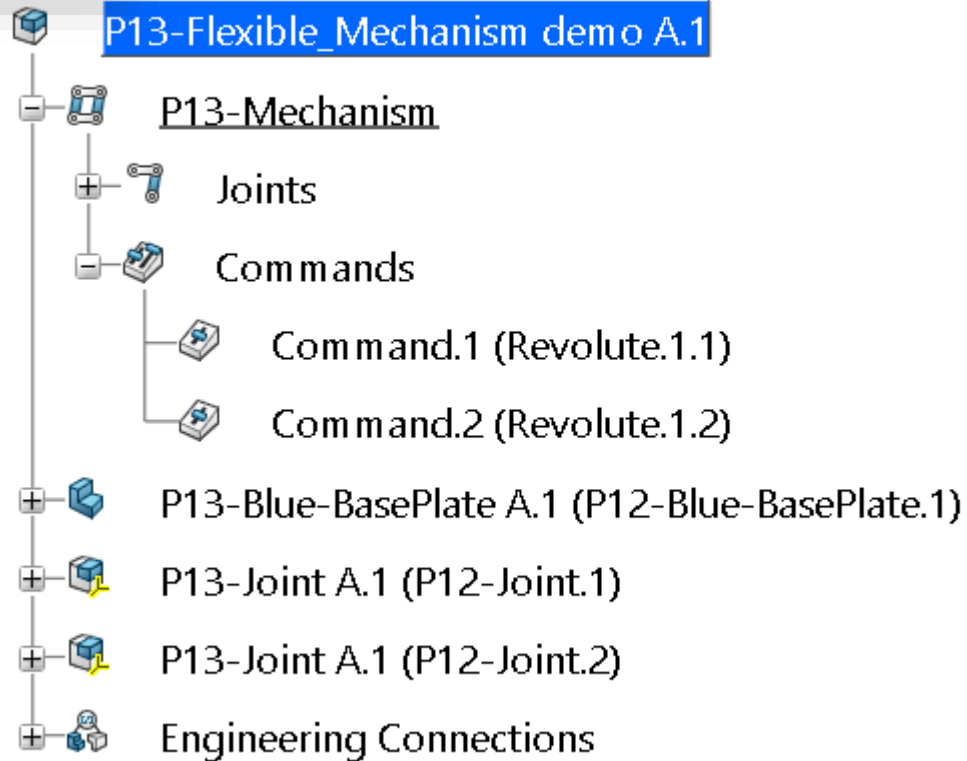
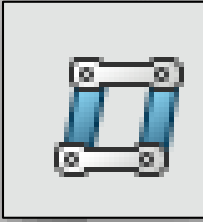

Add more EC's



- P13-Flexible_Mechanism demo A.1
 - P13-Mechanism
 - + Joints
 - Commands
 - Command.1 (Revolute.1.1)
 - Command.2 (Revolute.1.2)
 - + P13-Blue-BasePlate A.1 (P12-Blue-BasePlate.1)
 - + P13-Joint A.1 (P12-Joint.1)
 - + P13-Joint A.1 (P12-Joint.2)
 - + Engineering Connections

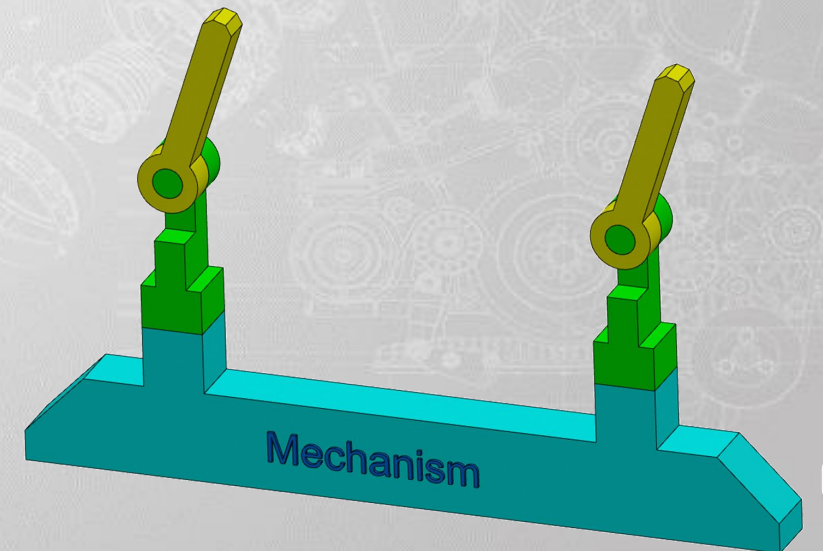

Add more EC's

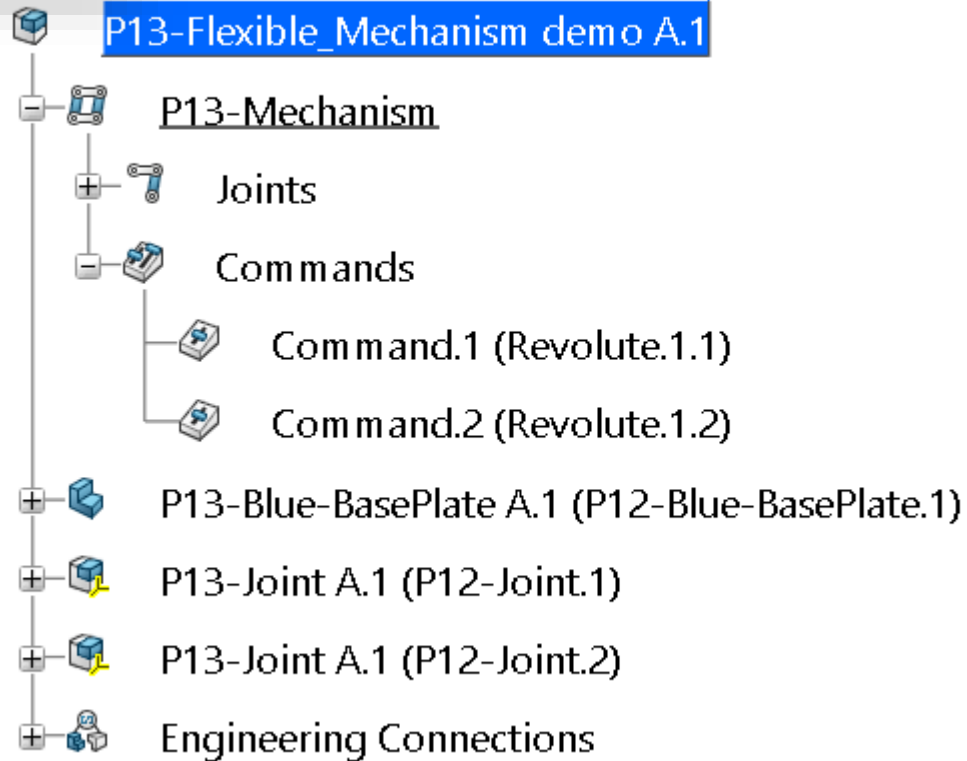
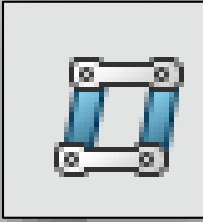

Mechanism Player

Mechanism status:

Command.1 -341.693	18.31	378.307	18.307deg			
Command.2 -341.693	18.31	378.307	18.307deg			

Reset All

Close

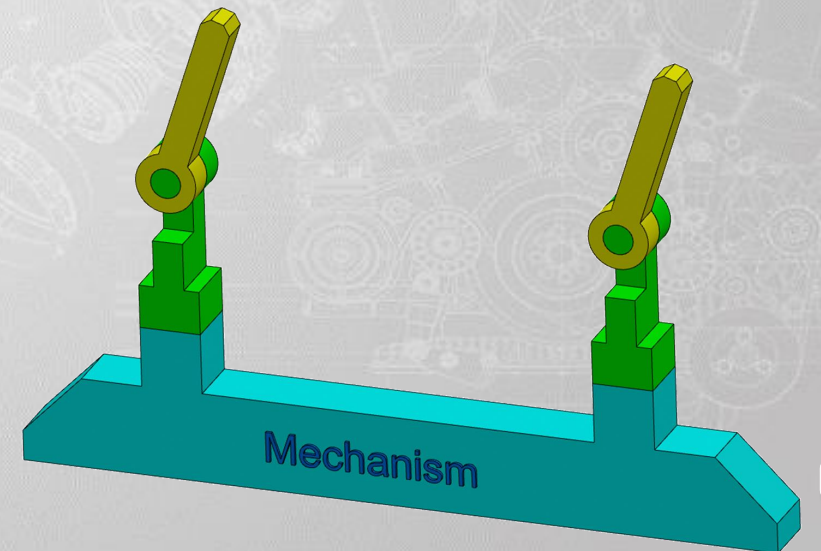

The End

